



Purpose:

This application is used for see report like bills, payment, bank balance, correspondence, processing fees etc. This application show report data in form of chart and list.

- **Currently this application contains following main menus.**

- A. Bills Issued.
- B. Bills Paid.
- C. Bank Balance.
- D. Payments.
- E. Correspondence.
- F. Payroll.
- G. GLReport.
- H. Processing Fees.
- I. Cashtribution Trans (Transaction).
- J. IGR.

Security Check:

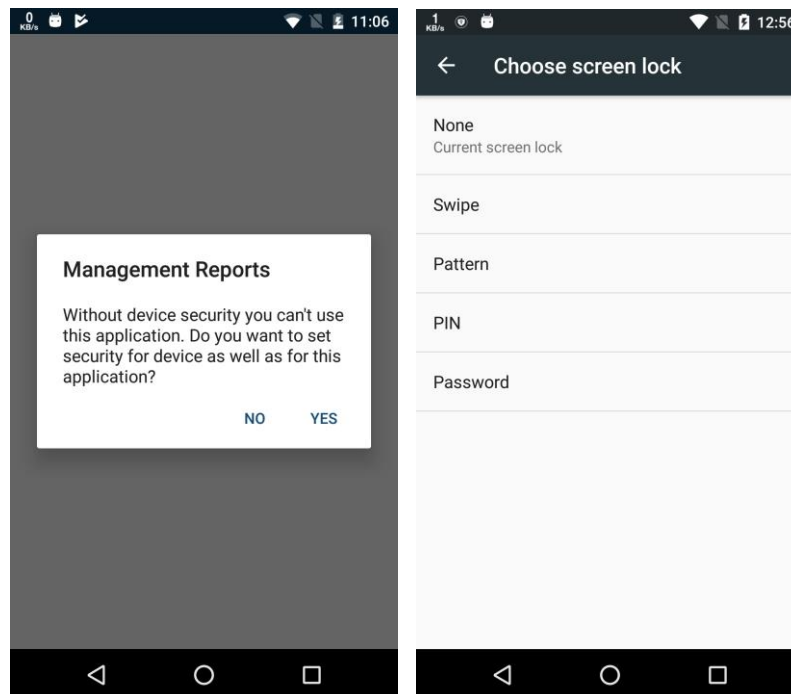



- When application starts, it will first check that device has security lock set or not if not then it will prompt message like above screen. If user click on “Yes” button of dialog then application will navigate to setting screen where user can set lock for device and as well as for application. Without device lock, application will not process further.

- **Splash & Login Screen:**

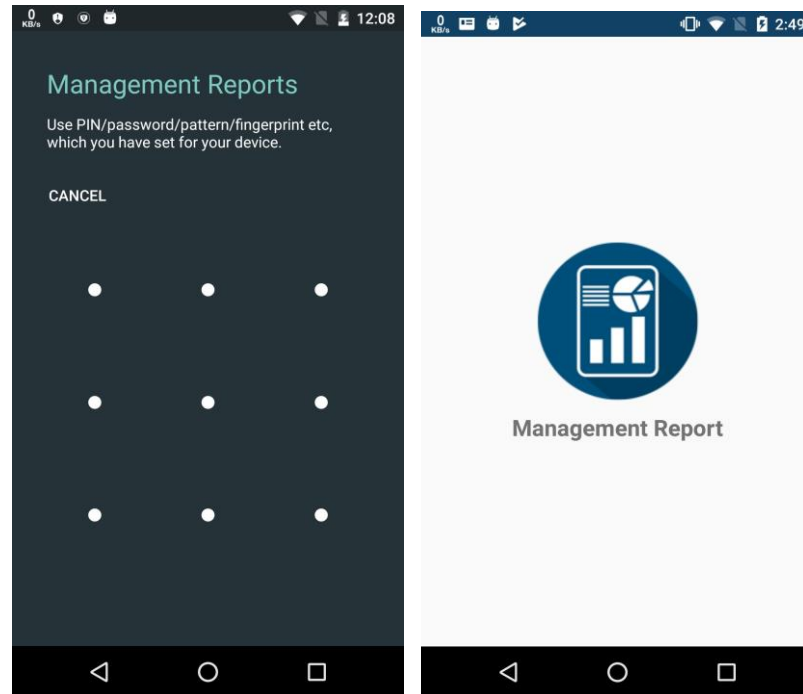

- If security lock set for device then application will ask user to unlock that security lock and if successfully unlock then it will show splash screen of application.
- After splash screen it will first check that device running latest application or not, if not then it will show prompt message like below screens and ask for download new version, if user click confirm then it will ask storage permission for download new version.
- Here user needs to allow storage permission to download new version, so app will download new version and then it will install it automatically.

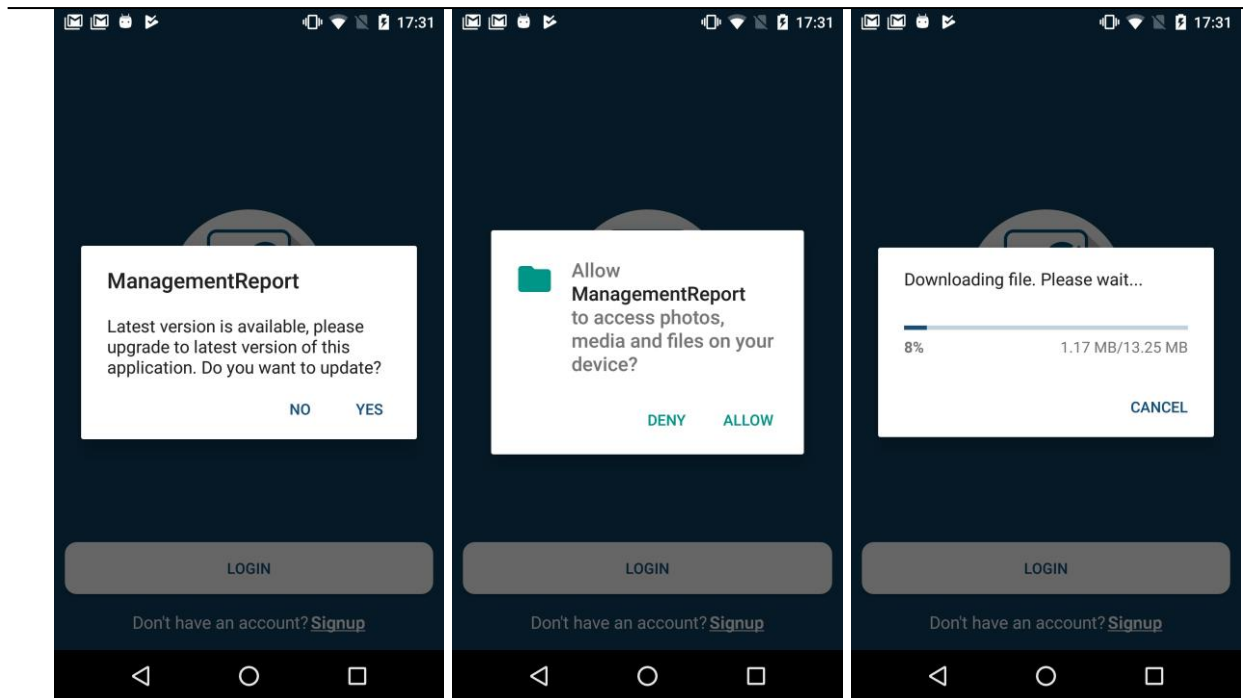

- User can also allow permission by going to app info => permission and assign specific permission.

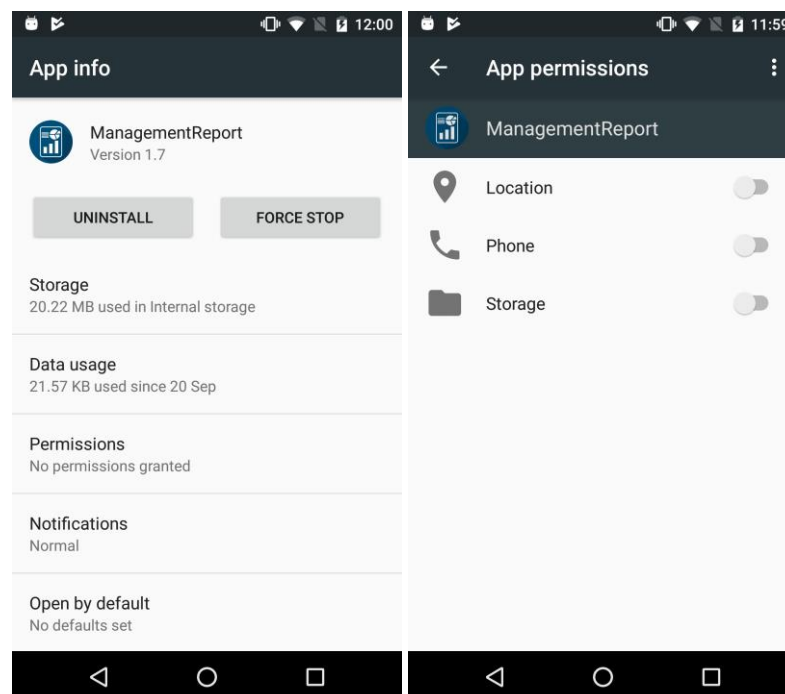

- If application is open after install for the first time then it will ask for some require permission like location because application require location for register device with ErpCrebit after that it will never ask user to start location.
- User must need to provide client name (eg. demo) in which client they want to process.



- If device not registered then it will ask for enable GPS and then app will ask phone country code and registered phone number.
- After click on “submit” button, app will send OTP on that provided number.
- If OTP received by that application device then it will register that device and navigate to menu screen.

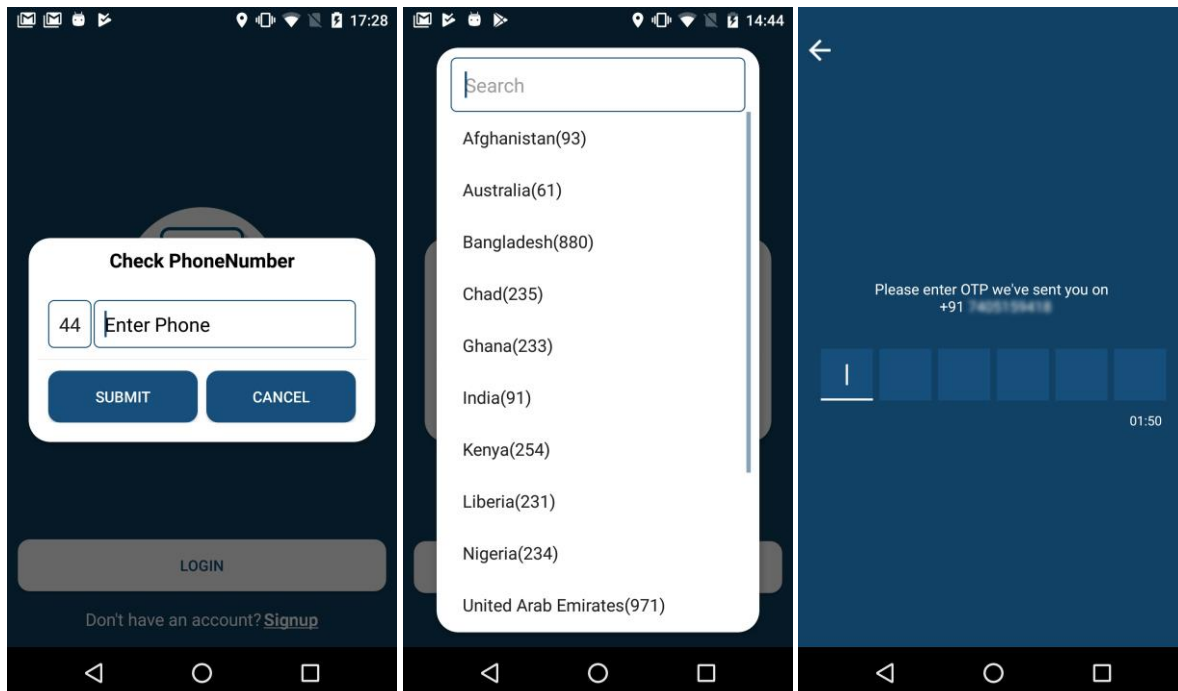
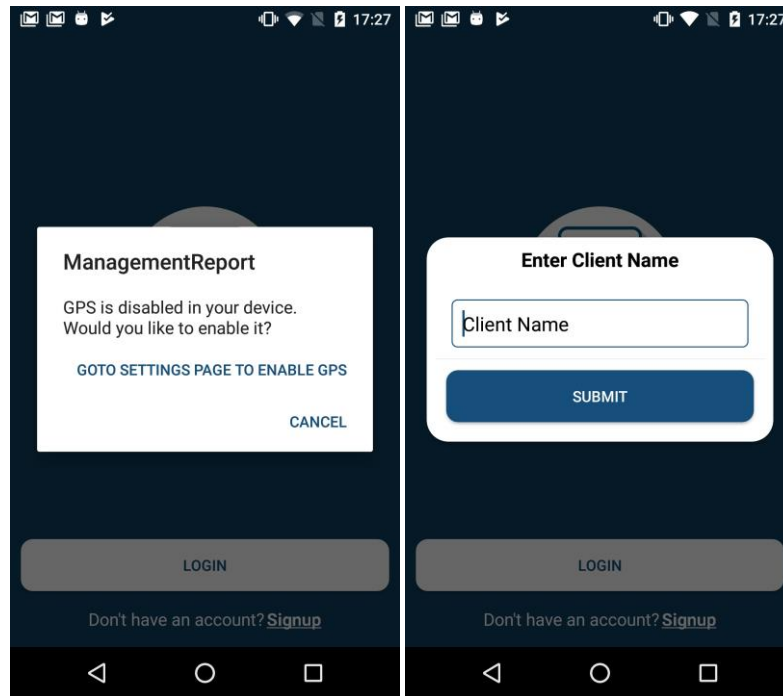



- In case OTP not received within two try then app will allow user to give missed call to server number, if server receive call from provided number then app will register that device and navigate to menu screen.

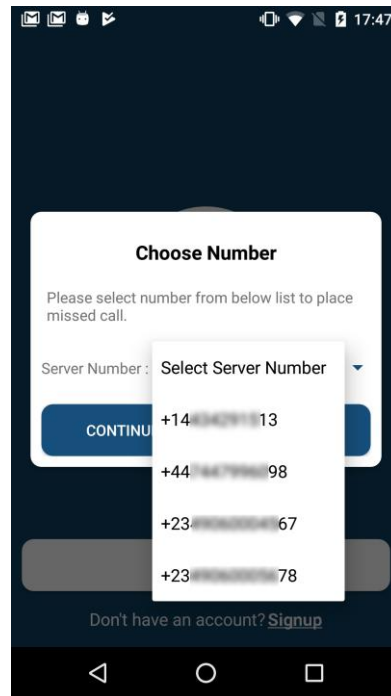

- If device is already registered then after providing option client name, app will login and navigate to menu screen.
- **SignUp:**
- If user does not have account on “ErpCrebit”, then user can create new account using app by clicking that “SignUp” link.
- This is step by step process, so user need to follow each step to register new account.
- In first step, user need to provide email-address, so app will send hash code on that email-address if that email-address not registered yet on system. If email-address already registered with “ErpCrebit” but with different client then it will show that client list and user can copy their account details from that client.

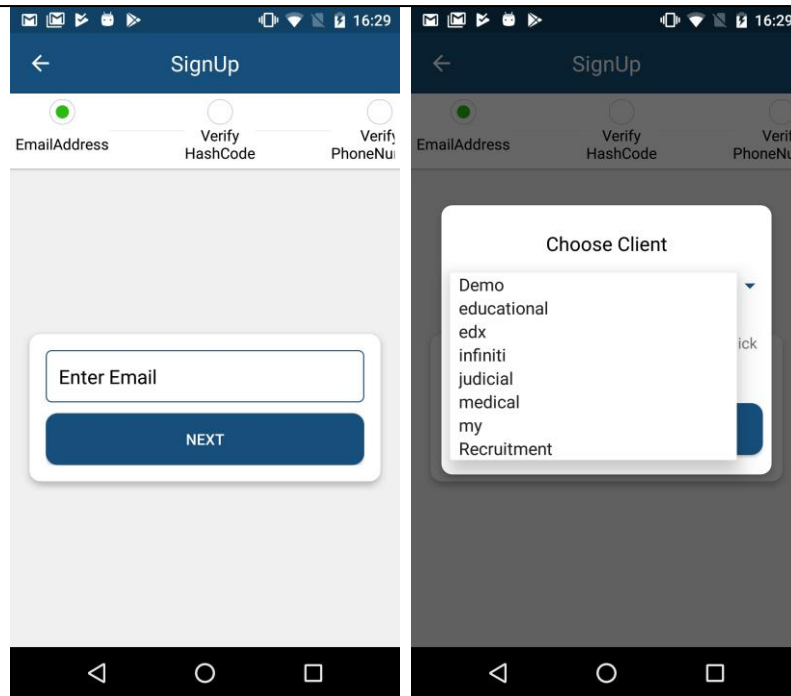

- In second step, user needs to provide that hash code in app to verify that email-address. If provided hash code match then it will navigate to next step.
- In third step, user need to select country code, provide phone number and need to select server number. As user select server number, app will automatically call on that selected server number.
Note: User needs to just place missed call on that server number.
- After placing missed call on server number user need to just click on that “Continue” button and app will check that server receive missed call from given number or not, if server received missed call from that given number then app will verify that phone number and navigate to next step.
- In fourth step, user need to setup their profile, here app will ask first name, last name, address etc.



SignUp

EmailAddress ☒ Verify Hashcode ☒ Verify PhoneNum ☐

Hash Code Verification

Please verify hash code sent to your email.

Enter Hashcode

NEXT

SignUp

EmailAddress ☒ Verify Hashcode ☒ Verify PhoneNum ☐

Phone Number Verification

Select Country Code

Enter PhoneNumber

Select Server Number

NEXT

Please select server number and call that number with your given phone number before proceeding.
NOTE: Drop the call as soon as it starts ringing.

SignUp

Verify Hashcode ☒ Verify PhoneNumber ☒ Setup Profile ☐

Title

Select Title

First Name

Enter First Name

Middle Name

Enter Middle Name

Last Name

Enter Last Name

Display Name

Enter Display Name

SignUp

Verify Hashcode ☒ Verify PhoneNumber ☒ Setup Profile ☐

Select Date Of Birth

Male Female

Full-Address

Enter Full-Address

Building Name Or Number

Enter Building Name Or No.

☐ Agree With Terms & Condition
☐ Subscribe To News Letter?

COMPLETE



- **Menu Screen:**

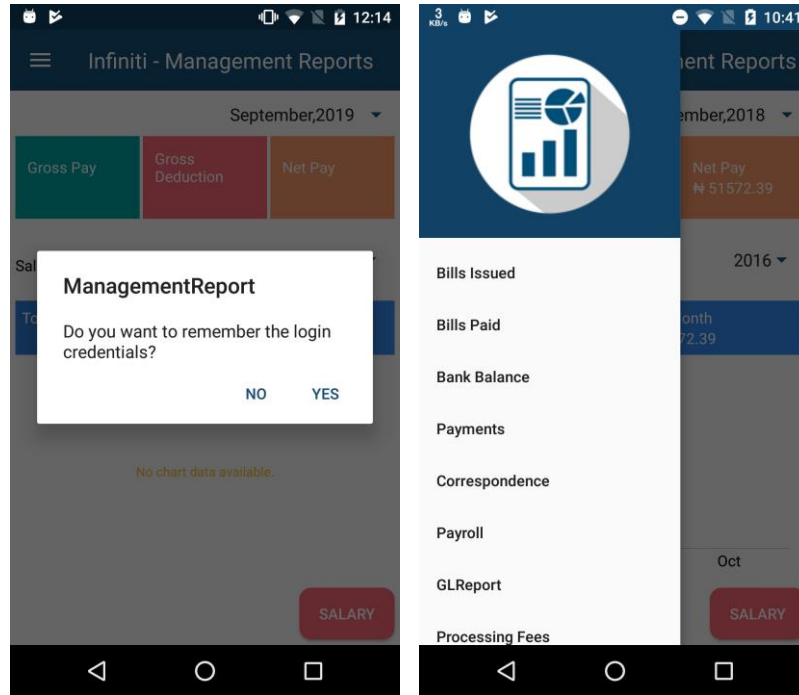

- After successfully login, application will navigate to menu screen. Here user it will show remember login option.
- If user clicks on “Yes” button then, app will not ask that login methods and it will directly allow that user.
- Here in menu screen user can navigate to any menu by choosing menu from drawer.
- User can change client from menu screen itself without going back to login screen.

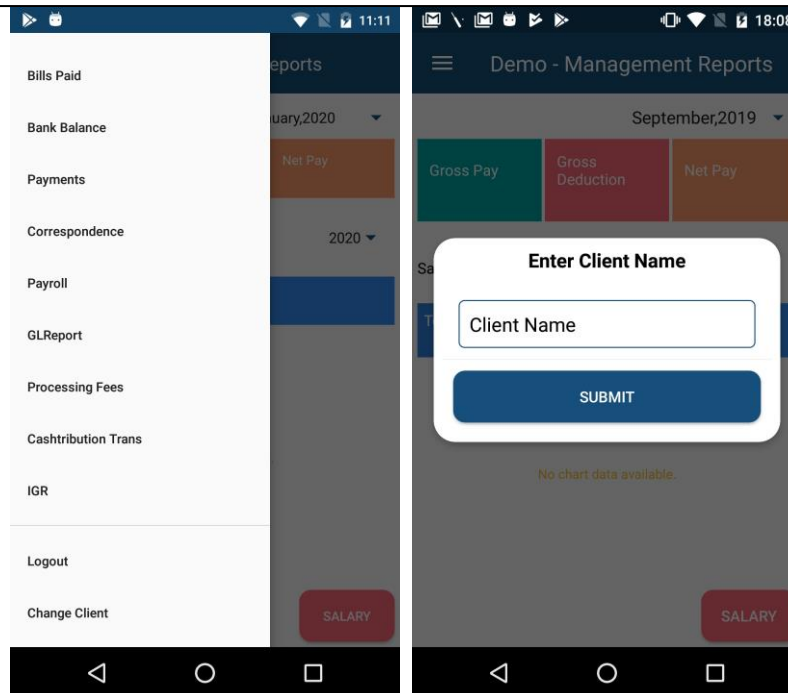

- **Application Dashboard:**
- Application dashboard will show line chart of total salary payment and also show "Gross Pay", "Gross Deduction" and "Net Pay".
- User can filter this line chart by selection year.
- By clicking on "Salary" button, user can see payment history details in form of pie chart as well as in list.

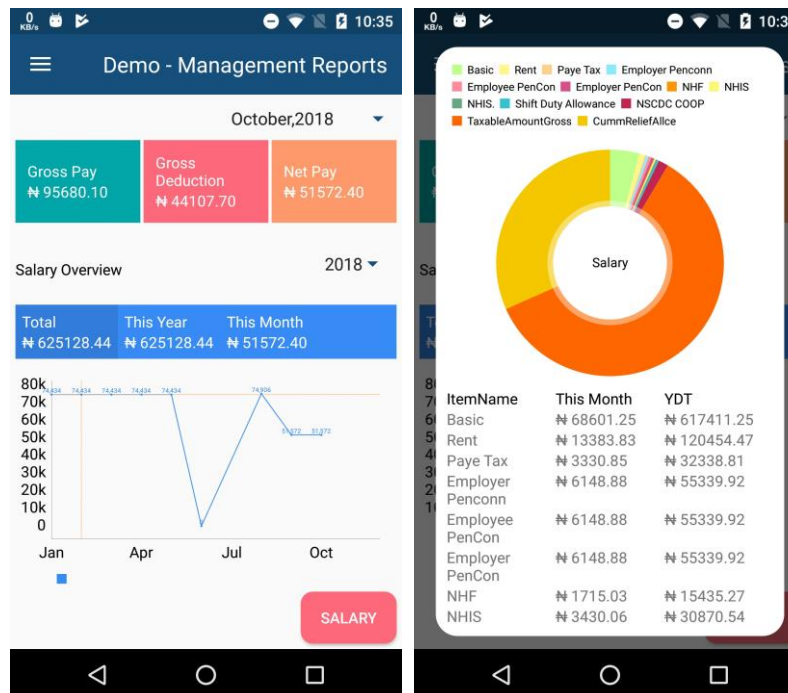



A) Bills Issued:

- In this menu application will show total issued bills of login user in chart.
- User can also filter it by selecting particular bill type, by default it will show data of all bill type.
- Chart will show data as current day and previous day, current month and previous month and current year and previous year including amount and quantity.

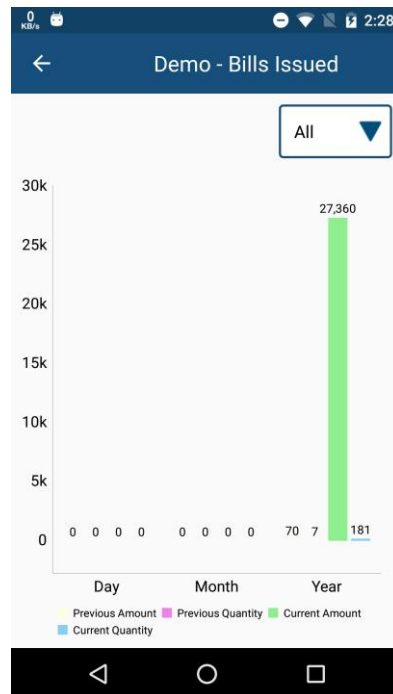



B) Bills Paid:

- Using this menu, user can get data of total bill paid in form of chart. As like “Bills Issued” menu here also user can filter bill paid by selecting bill type.
- Chart format is same like “Bills Issued” menu.

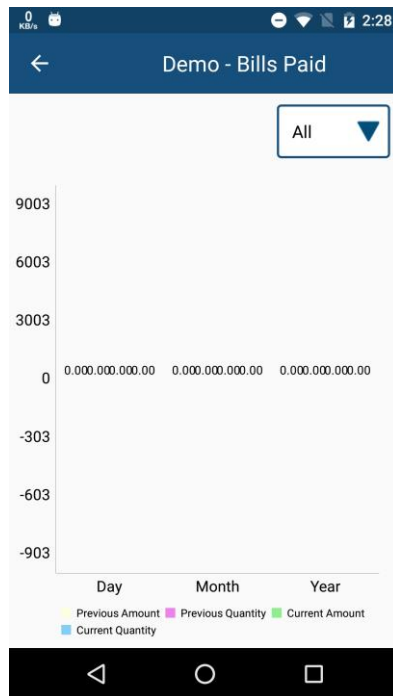



C) Bank Balance:

- This menu show bank balance of login user in form of chart.
- To get bank balance chart, user need to first select their bank account for bank account list.
- After selecting bank account, need to click on submit button and it will show chart of bank balance.

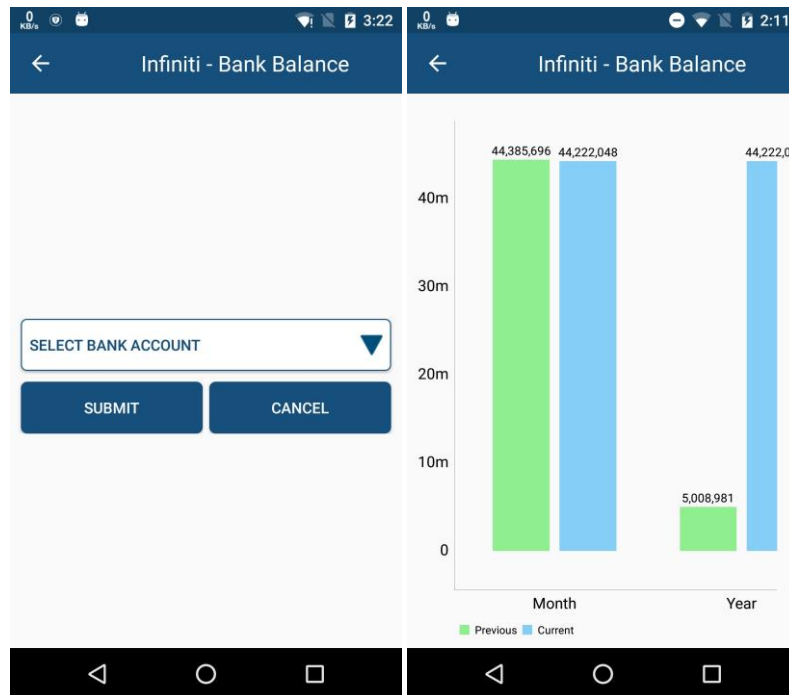



D) Payments:

- Using this menu user get their total payment in form of chart. Chart format is same like other chart.

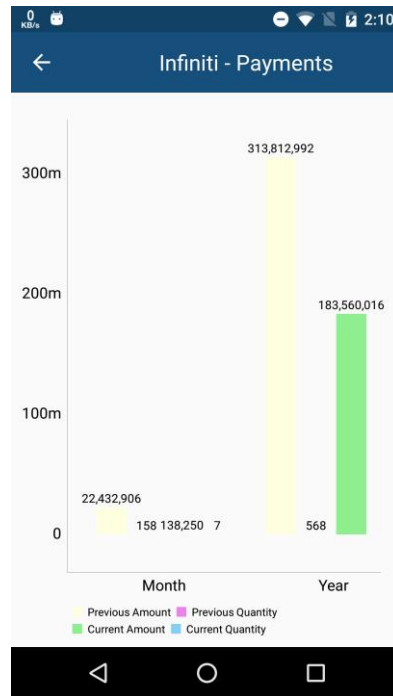



E) Correspondences:

- This menu will show top 10 correspondences. User can also see the details of particular correspondence and its attachment by just click on any correspondence.

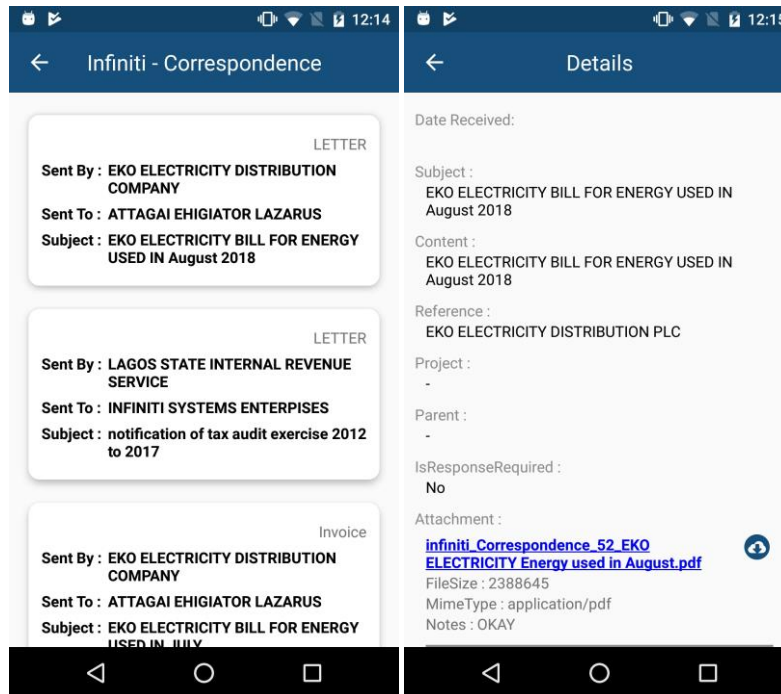

- User can download that attachment by click on download button.
- If application does not have storage permission then it will prompt message because without allowing permission app will not download that file in device so user must have to allow storage permission.

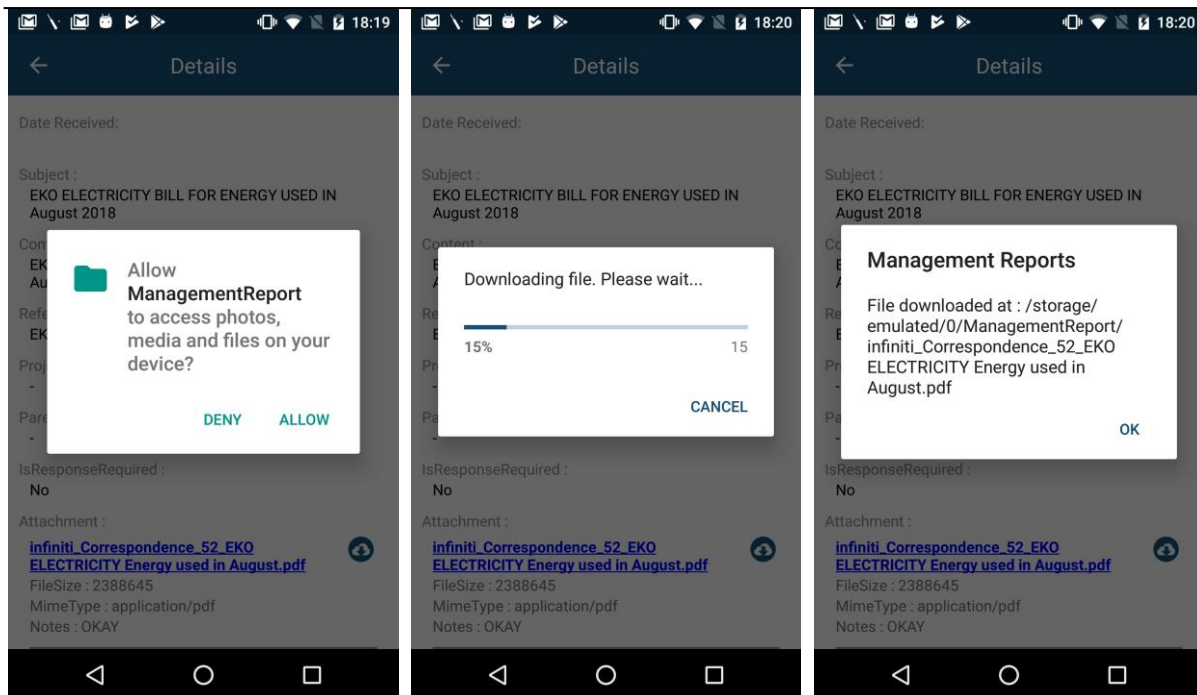

- If user does not want download then they can directly view this attachment.

F) Payroll:

- Using this menu user can see chart for payroll, application will show payroll chart based on selection. User must need to select option from first screen without selection it will not process further.

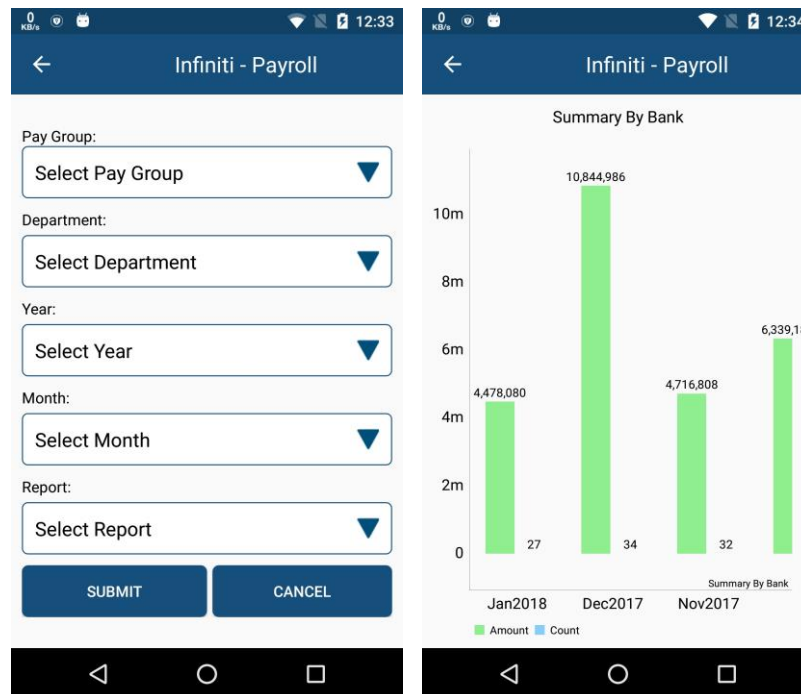



G) GL Report:

- In this menu user can see GL Report chart. First user need to select option from first screen, here “Start Date”, “End Date” and “Currency” are require. Other options are optional based on user requirements they can choose.

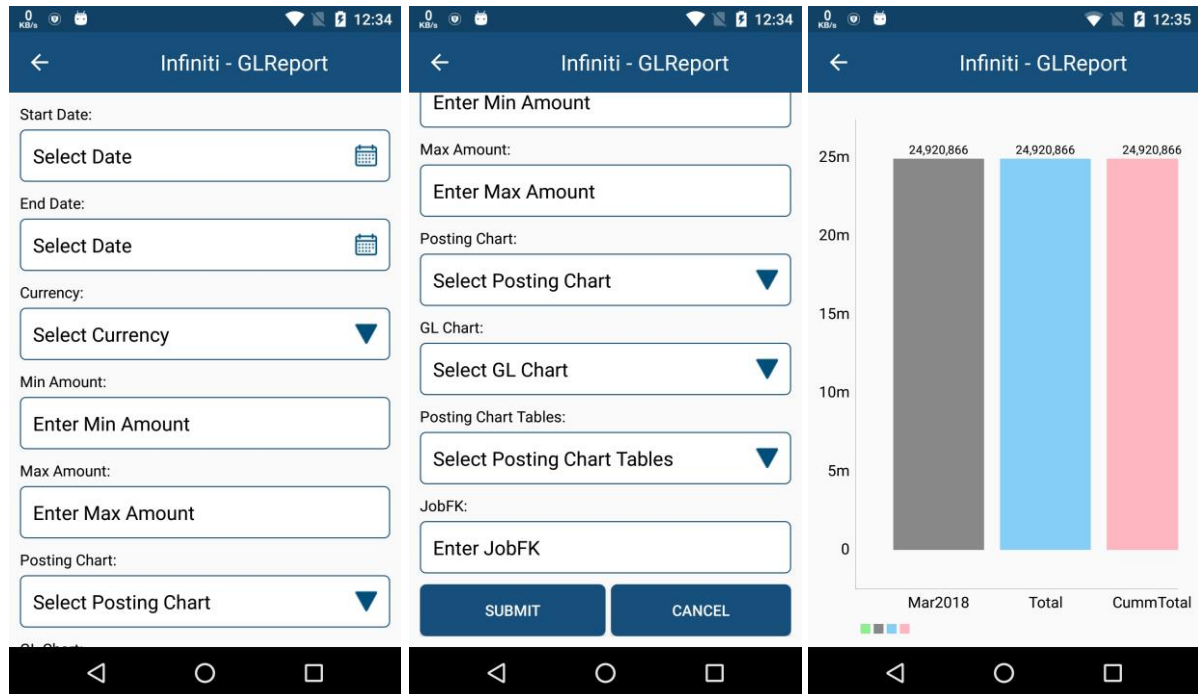

H) Processing Fees:

- If users perform any transaction or pay any bill using IPP (Infiniti Processing Platform) then it will take processing fees per transaction, so this menu will show report about processing fees that how much they had paid for fees.
- This menu show report in form of chart, chart will show data like currentDay-previousDay, currentMonth-previousMonth and currentYear-previousYear.

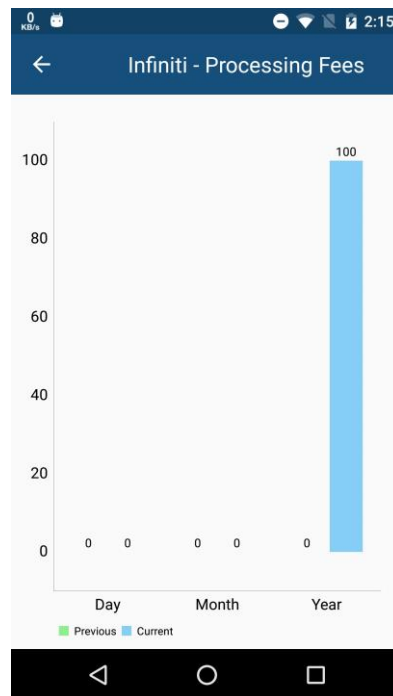

I) Cashtribution Trans:

- In this menu user can see report of transaction performed using cashtribution application.
- Application will show report in form of chart as well as in list form.
- To see list, user need first change mode form selection control and need to choose start date and end date.

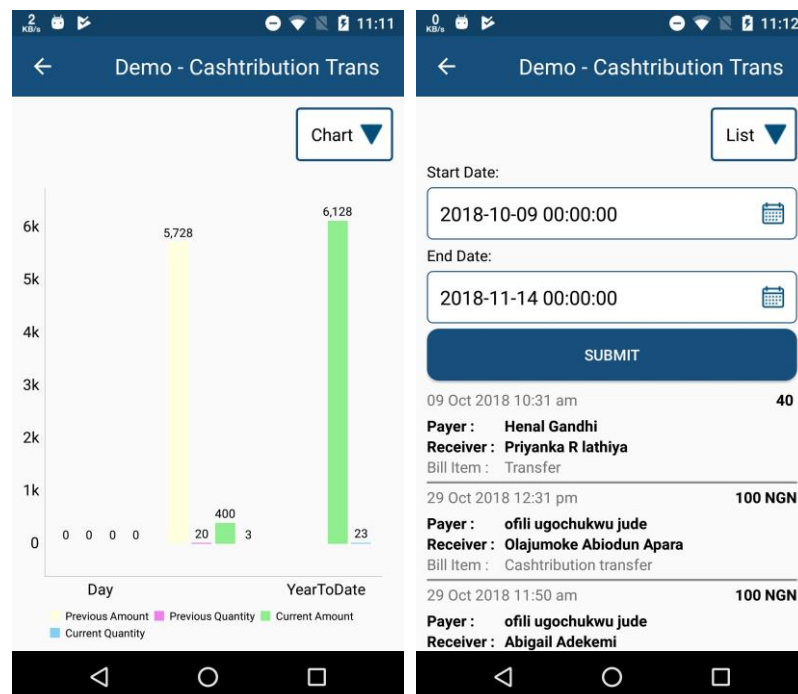



J) IGR:

- In this menu user can see reports in form of chart and in list of collection reports, tax payers and banks.
- User can filter data based on year and month.

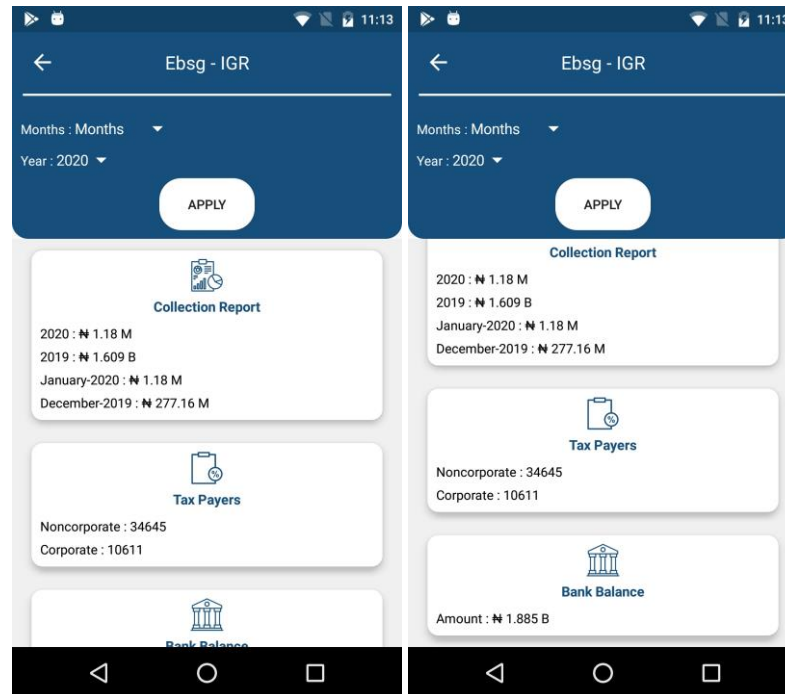

- Above is main dashboard screen where user can see current year , current month and previous year previous month total collection, total tax payer and bank balance.
- User can see collection report by clicking on collection tab, in that screen app will show pie chart for total year base amount and bar chart for individual item type in tab layout.
- User can also download report data in form of csv.

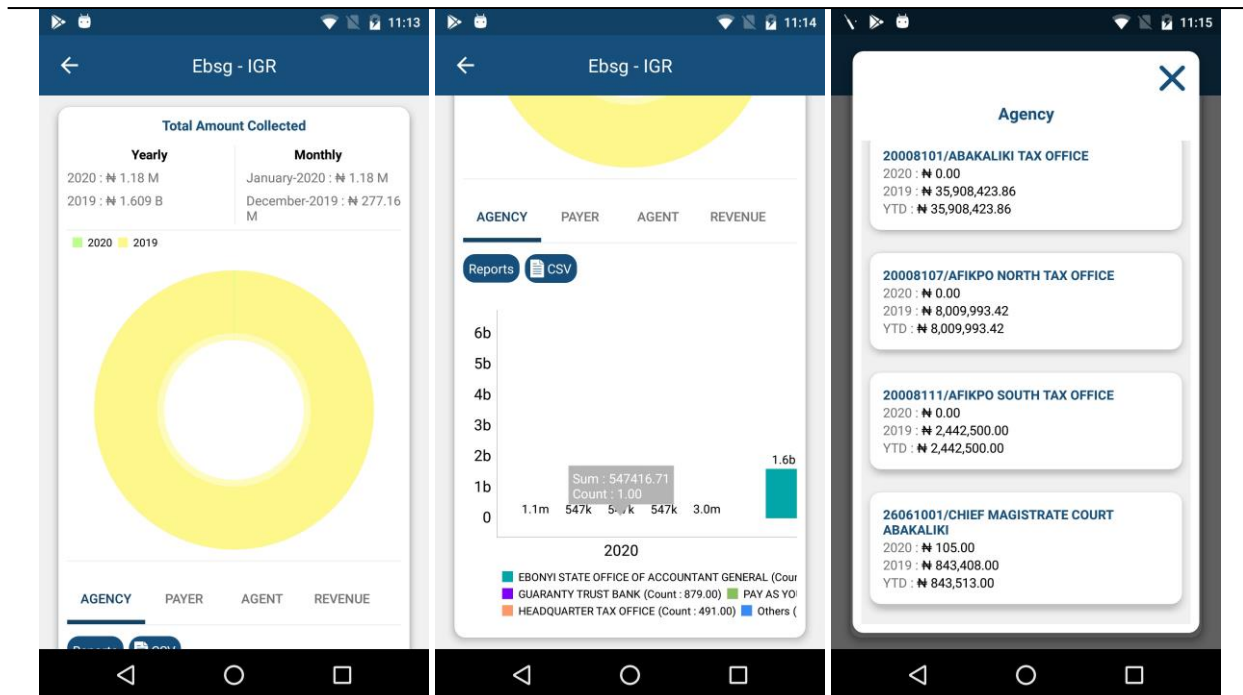

- In tax payer tab user can see noncorporate and corporate tax payers and in bank tab user can see list of bank with bank-balance.

